



2024 GOLD MEDAL AWARD SUBMISSION



Angela
Mazzi
FAIA
FACHA
EDAC

TABLE OF CONTENTS

Biography and Nomination

Nomination Letter: Doug Richards, FAIA, CPHD, LEED AP
Component Letter: Zoe Gizara, AIA

Significant Accomplishments

Honors and Awards

Leadership and Service at local, state and national levels of AIA

Leadership and Service in Healthcare Design

Leadership and Design impact on the profession

Service within the community and the industry

Exhibits

Leadership: Advancing Salutogenesis

Leadership: Advancing Equity

Service: Architecting Community

Service: Architects as Healers: Buildings as Medicine

Service: Mentoring of Young Professionals

Design: Oncology

Design: Behavioral Health

Design: Staff Environments

Design: Integrating research and practice

Letters of support:

John Rogers FAIA, FACHA,

Steve Templet AIA, FACHA

Christopher Haedt AIA, NCARB, ACHA, LEED AP BD+C

Roderick Walton FAIA NCARB NOMA

Bill Ayars FAIA, FACHA

Yazitza Brongers Marrero FAIA, NOMA, NCARB, LEED AP BD+C, LEED FOR HOMES

Sara Bayramzadeh, PH.D., M.ARCH

Alex Oetzel, AIA

Contact Information

Angela Mazzi, FAIA, FACHA, EDAC

GBBN Architects

332 East 8th Street

Cincinnati, OH 45202

216-288-4398

amazzi@gbbn.com

At A'23 last year, Angela had lunch and attended a Women in Architecture event with one of her Align program mentees, caught up with a fan of the Architects as Healers: Buildings as Medicine Clubhouse room, celebrated with a friend's elevation to fellowship, caught up with a colleague she met while speaking at a conference in Hong Kong, hung out with the AIA Cincinnati contingent, attended the AIA Ohio reception, caught up with some healthcare colleagues (and another newly elevated fellow whose nomination she supported), got some zen time in the Expo hall, and managed to randomly find one of her VISION classmates who now lives in Tulsa.



EMPLOYMENT

GBBN Architects, Cincinnati, OHJuly 2011 - Present

Principal, Researcher and Senior Medical Planner

Leader, Healthcare Futures Group

Leader, Medical Planner Group

Equity Task Force – advancing project process

Westlake Reed Leskosky, Cleveland, OHMar. 2003 - Sept. 2010

Associate Principal, Director of Healthcare Planning

The Stichler Group, Phoenix, AZAug. 1999 - Sept. 2002

Associate, Project Architect

GBMA Architecture, Phoenix, AZSept. 1995 - Aug. 1999

Project Manager

PROFESSIONAL LICENCES AND CERTIFICATIONS

- Registered Architect: Arizona and Ohio
- American College of Healthcare Architects Certification (ACHA)
- National Council of Architecture Registration Boards (NCARB) Certification
- Evidence-Based Design Accreditation and Certification (EDAC)

EDUCATION

- Carnegie Mellon University 1993
 - Bachelor of Architecture Degree
 - Minors in Industrial Management and Architectural History
- University of Arizona 1995
 - Master of Architecture Degree
 - Concentration in Sociology and Cultural Impacts of Design

CHILDHOOD Exploring the feeling of space

BARCH Understanding how design impacts experience

MARCH Researching Socio Cultural issues in Design

EARLY CAREER Understanding practice Service to the community Advocacy

MID CAREER Understanding practice Service to the community Advocacy

POST FELLOWSHIP Understanding practice Service to the community Advocacy

AIAS
Advocating for career path

AIA PITTSBURGH
Architecture for children at risk grant

GOVERNOR'S SCHOOL
Taught architecture program for high schoolers in Youngstown

AIA PHOENIX METRO
Community Service

COMMUNITY
Arizona Forward
Phoenix Housing and Neighborhoods Commission
Phoenix Revitalization Corporation
Arizona State University
Community Charrettes

AIA CLEVELAND
Government Affairs Committee

ACHA
Multiple Committees
Board Leadership
Future of Healthcare

AIA CINCINNATI
Board Leadership

SALUTOGENESIS RESEARCH

EQUITY FRAMEWORK

MENTORING

PATRON SAINT OF ARCHITECTURE BLOG

ARCHITECTS AS HEALERS: BUILDINGS AS MEDICINE

ARCHITECTING PODCAST AND COMMUNITY

SPECIALIZATION IN HEALTHCARE

BIOGRAPHY

From her first national publication in AIAS CRIT magazine back in 1993 to being an outspoken voice in the profession today.



Space feels like something. That's something I've been aware of since childhood. It's what led me to build imaginary structures out of Legos, cardboard boxes, and anything else I could get my hands on. What led me to explore how the kitchen felt like a whole different room when I climbed on top of the refrigerator. As I got older, I doodled in the margins of my lined notebook paper creating section elevations of apartments and floor plans for homes.

Despite all these tendencies, **I didn't know I wanted to be an architect.** No one in my family had pursued a creative career, we didn't know anyone who was an architect. My mother was the one who connected the dots and arranged for me to tour what was then Buchanan, Ricculti and Balog partners in our Youngstown community. I realized that architecture combined so many of my interests and sensibilities, and wanted to help others also make this connection.

At Carnegie Mellon, I was inspired by Vivian Loftness, FAIA and Stefani Danes, FAIA. Vivian was one of the pioneers of the sustainability and resilience movement. Her groundbreaking research in environmental design inspired me to think about the impact design can have to create a better world. But it was Stafani's class, The Psychology of Habitation that was life changing. **I learned that design impacts behavior and can be used to promote well being.** At the University of Arizona where I focused specifically on socio cultural issues in design, writing my thesis on the impact that telecommuting was having on our understanding of home and work as places,

My first job at GBMA in Phoenix opened the door to ways to leverage these interests through practice. My boss, Manuel Agirre, AIA promoted me to project manager six months after I started and actively engaged me in discussions about business development. **Some might have considered me too young and inexperienced, but he didn't doubt me, so I didn't doubt me.**

I learned how to build a website, designed a new logo for the firm, was sent to my first few national AIA conferences and was encouraged to be active in my community, leading me to join Arizona Forward and apply for a seat on the Housing and Neighborhoods Commission. I was also actively supported in my quest to get licensed as soon as possible.

At my next job at the Stichler Group, Partner Leslie Hanson, AIA encouraged involvement with AIA Arizona and was an advocate for women architects. She nominated me for the AIA Arizona Young Architect Citation and encouraged me to **ask for and make opportunities in my career while being a servant leader.**

Family health concerns led me to leave Phoenix and pursue work in Cleveland to be closer to my parents. This time spent at Westlake Reed Leskosky saw my career transition from community advocacy and affordable housing to healthcare. My father had wanted me to be a physician like him -while I didn't resonate with that, **I realized could be a healer as an architect.** The things I cared about as an architect were amplified in healthcare - a high stress environment laden with technical requirements and devices. with little opportunity for users (even staff) to make changes to suit their needs. We need to get it right in or lock people into what could be decades of design that creates more stress and impedes healing. Buildings could be medicine. **This was the beginning of my work in salutogenesis, which has become a career-defining topic for me.**

At this mid-career point, I encountered disillusion in myself and my colleagues. The ideals we had in our early careers had been weighed down by the realities of getting a competent project that the client was happy with out the door. I realized that having an effective project process was as critical as being a good designer. **It was also crucial to empower my colleagues who had become so disconnected from their dreams that design really can make a difference.** I began blogging as The Patron saint of Architecture in 2010, and rebranded to Architecting when I launched my podcast in 2021.

The last twelve years of my career have been spent at GBBN in Cincinnati where I have had so many wonderful resources and so much agency to develop my point of view as a healthcare architect. I am a practice leader and an internationally recognized expert in healthcare design. I've leveraged those industry contacts to help others learn more about how design can be healing through my podcast Architects as Healers: buildings as Medicine. I've been recognized as a Fellow in both AIA and ACHA for my work in salutogenesis, advancing project process and advocacy. My past mentors were wayshowers and set an example I've strived to follow. **I am committed to positively impacting others and the profession by to giving generously of my time.** This is why I guest lecture, mentor others, speak and publish regularly. No one can understand our value as architects if we don't share our work and the ways that it impacts others.



June 28, 2024

John Meagan, AIA President: AIA Ohio Board of Directors
400 Wilson Bridge Road, Worthington OH 43085

Re: AIA Ohio Gold Medal Nomination

Dear Mr. President and Honor Awards Jury

Angela Mazzi, FAIA, FACHA, EDAC is a commendable candidate for the AIA Ohio Gold Medal due to the impact she had had to the profession. Throughout her career, she has been able to advance the practice of healthcare **Design**; provide **Leadership** to a broad range of professional organizations; while also dedicating her time to selflessly **Serve** others-aiding in their career and personal growth.

I have been fortunate to know Angela for over a decade and see her excel on many fronts. I first met her while directing our local Architect focused leadership program: AIA VISION. She volunteered to help craft future versions of the program while also being a local speaker showcasing her expertise in **Salutogenesis, Equitable Design and Advancing Research**. We later found ourselves working at the same firm the year we were both elevated to FAIA. After that I became acutely aware of how she is recognized and **sought after as an expert** in her field by clients and healthcare related organizations from across the world. The list of her speaking engagements alone is astounding.

As an Architect and Medical Planner, Angela touches many award-winning projects- advancing the impact buildings can have to revolutionize care processes and elevate patient and staff experiences. Her work has developed industry models for several health care fields that are now used nationwide. You can review her application to see all the accolades, but the one that stands out to me was being named a **Top 10 Architect in the Nation by HealthCare Design**, the premiere source for design in the Health Care Industry.

Wherever her life has taken her, Angela recognized the importance of not only participating in professional organizations, but also the necessity to bring her skills to lead them. Her long-term commitment has developed programs, learning opportunities, and planning for these institutes that have had a positive impact on the members and the outreach they have pursued. The AIA and the ACHA recognized this attribute of Angela through her leadership efforts by elevating her to **Fellowship, the highest honor bestowed by both**.

But the thing that impresses me the most is what Angela does in her spare time. She has embraced her love for advancing the design of buildings and research by cohosting a weekly social audio show ARCHITECTS AS HEALERS and her devotion to provide professional career development with the podcast ARCHITECTING (ranked #20 by Podcast Magazine). Service is the intangible act of helpful activity towards others. **Angela's passion to make the profession the best can be seen by how she volunteers.**

Without a doubt, I can honestly nominate Angela Mazzi for the AIA Ohio Gold Medal without any reservations.

Sincerely,

Douglas Richards FAIA, CPHD, LEED AP
Associate Principal + AIA Cincinnati Past President



June 28, 2024

AIA Ohio
400 W. Wilson Bridge Road, Suite 120
Worthington, OH 43085

To: AIA Ohio, Honors Awards Jury

AIA Cincinnati is proud to support Angela Mazzi, FAIA, FACHA, EDAC for the AIA Gold Medal Award.

Angela is an energetic, passionate professional whose groundbreaking research and tireless dedication to leadership and service has made positive and lasting impacts, both locally and beyond.

Angela's years of research at the intersection of architecture, salutogenesis and medical planning is on the leading edge of transforming how architects approach design through the lens of wellbeing. Angela's expertise has garnered widespread recognition, evidenced by regular invitations to serve as guest juror and speak at universities and national forums alike.

In service to the profession of Architecture, Angela works tirelessly on behalf of design excellence, professional advocacy, and in mentorship of the next generation of architects. In planning the 2019 OVR conference, she ensured quality programming and opportunities for emerging professionals. In her tenure as Director, and subsequently President Elect and President of AIA Cincinnati, Angela was at the center of developing a fresh strategic plan for the chapter and successfully restructured how our committees collaborate to provide relevant, engaging programs for our members.

As the first female Fellow in Cincinnati, Angela serves on the Fellows Council and coaches others through the Fellowship process. Whether in her work to help support our newly formed Ohio Valley NOMA Chapter, her participation in advocacy efforts at the State and local levels, or via her audio show, *Architects as Healers* and podcast, *Architecting*, Angela consistently strives toward broadening others' understanding of how the world can be and how we as architects, through design and engagement can be the agents of positive change.

I fully endorse Angela Mazzi's nomination for the AIA Gold Medal Award and encourage the Jury's full and thoughtful consideration.

Sincerely,

Zoë A. Gizara, AIA
President, AIA Cincinnati

Zoë Gizara, AIA
MSP Design
President

Paul Shirley, AIA
Pelican Studios
Vice President/President Elect

Monica Lowry, AIA
Burgess & Niple
Treasurer

Rob Busch, FAIA
drawing dept
Secretary

Chris Bartell, AIA
GBBN
Director

Ross Battoclette, AIA
Champlin Architecture
Director

Alberto Gomez, Associate AIA
CHMA
Director

Christopher Hernandez, AIA
Jacobs
Director

Jen Choto, Associate AIA
BHDP
Associate Director

Allison McKenzie, AIA
SHP
AIA Ohio Representative

Karen Planet, AIA
RWA Architects
Alternate AIA Ohio Representative

Angela Mazzi, FAIA
GBBN
Past President

Julie Carpenter
Executive Director

1308 Race St Ste 104
Cincinnati, OH 45202
T 513.421.4661
M 513.609.2757
info@aiaincincinnati.org

SIGNIFICANT ACCOMPLISHMENTS

HONORS AND AWARDS

AIA Ohio Charles J. Marr Award 2023

AIA Cincinnati nominated Angela for this award for exemplary commitment to the profession. She was recognized for her accomplishments as a Board Member and President, including many initiatives that raised awareness of the chapter in the community and increased engagement of members..

Podcast Magazine #20 Rank 2022

Angela's Podcast Architecting was recognized as one of the top podcasts by moms by Podcast Magazine. This ranking was based on quality of content and audience votes.

Loth 100 Minds Thought Leader Award 2012

The Thought Leader Award praises individuals in the Ohio region who have contributed to community building, innovation or leadership within their industry.

AIA Arizona Young Architect Citation 2001

Angela received this award for her work in the Phoenix community and leadership/advocacy for social determinants to health like affordable housing and healthy neighborhoods.

AIA Central Arizona President's Commendation 2000

Recognition for service to the profession and supporting the work of the local chapter.

Phoenix Revitalization Corporation Service Award 2020

Awards are given to individuals who have made a significant contribution to advancing the cause of the organization and supporting the Central City South Neighborhood.

Arizona Forward Leadership Award 1999

Angela was recognized for her work leading the Land Use Subcommittee through several successful initiatives. Leadership Awards are presented to those in the Phoenix Metropolitan area who have made significant contributions to the organization.

"I have had the privilege of working with Angela through various professional collaborations, and I am continually impressed by her impact on the field of healthcare architecture. Her extensive expertise in salutogenesis, medical planning, and her commitment to advancing healthcare design make her an exemplary candidate for this prestigious award.

Angela's innovative work in salutogenesis and evidence-based design has significant contribution to healthcare architecture. Her research on health-generating buildings and user-centered design processes has set new standards in the industry. As a Partner and Senior Medical Planner at GBBN Architects, Angela has led innovative projects that integrate strategic design strategies to improve well-being and operations. Her contributions to academic and professional discourse are evident through her numerous publications in esteemed journals such as the Health Environments Research & Design Journal and Healthcare Design Magazine.

She has shared her insights on the cognitive and biological effects of design on health. Moreover, her service on academic juries and invited lectures at Kent State University highlights her commitment to nurturing the next generation of architects and advancing the field through education."

Sara Bayramzadeh, Ph.D., M.Arch.
Associate professor
Program Coordinator in Healthcare Design
College of Architecture and Environmental Design

HCD 10 TOP ARCHITECT 2022

Angela received one of the highest awards in the healthcare industry for elevating the application of research in design, specifically in the healthcare design sector. Her peer-reviewed salutogenesis research demonstrates how health outcomes can be impacted by reducing stress and promoting well-being, leading to her becoming a sought-after expert in the design of oncology, behavioral health, and emergency departments as well as clinical workspaces.

Her work to bring quality care to underserved populations, especially those with mental health conditions, is reframing the approach to these care environments by supporting a new model of programming to reduce patient aggression, shorten inpatient stays, and increase staff retention.



FELLOWSHIP

AIA Fellowship 2020

Awarded for advancing healthcare practice technically based on salutogenic measures, reimagining project process and advocating for research-based design. Angela was recognized for developing and sharing evidence-based processes that evolved standards for healthcare research and design while advocating to improve the relationship between experience and environment.

As a Pandemic Fellow, Angela's convocation ceremony was held jointly with the class of 2021 at the Kennedy Center during the AIA Leadership gathering in December 2021.

ACHA Fellowship 2019

Angela was awarded Fellowship because of her use of evidence-based design and Lean principles to understand and improve healthcare environments. Her work advances empathy and positive outcomes by incorporating salutogenesis (health generating buildings) and a user-centered process. Her career advances the science and art of planning and building; advancing the standards of healthcare research and practice by improving the relationship between experience and environment



SIGNIFICANT ACCOMPLISHMENTS

DESIGN AWARDS



NORTON HEALTHCARE NOVAK CENTER FOR CHILDREN'S HEALTH

Completed: 2018 Size: 174,000 s.f.
Role: Research, Lean Design

Angela's research on salutogenic design led to introduction of many elements that reduce stress. Gardens, green roofs, organic forms, and nature elements provide relief for staff and patients. Workspace research led to task-based design. Post occupancy findings show wait times have shortened and interdisciplinary communication is improved. IAQ Improved through chilled beam system.

- 2022 ASHRAE Technology Award, First Place Winner
- 2022 IIDA National Healthcare Design Award, Ambulatory Pediatric Category Winner
- 2019 ACEC Georgia Engineering Excellence Award, Norton Healthcare



TRIHEALTH THOMAS COMPREHENSIVE CENTER

Completed 2020 Size: 140,000 s.f.
Role: Research, Lean Design, Medical Planning

Angela developed model of care that led to clinical module platforms with multidisciplinary workrooms at the heart. All of the principles of salutogenesis were employed to provide an immersive care experience that would extend beyond treatment of disease. The design revolutionizes care processes and elevates the patient and staff experience. This project has become a model for oncology care in the industry.

- 2022 AIA Ohio Merit Award
- 2022 IIDA National Healthcare Design Award, Ambulatory Cancer Center Category Winner
- 2022 The Center for Health Design, Healthcare Environmental Award, Ambulatory Center Honorable Mention
- 2021 IIDA Cincinnati, Honor Award



CLEVELAND CLINIC TWINSBURG CAMPUS

Completed: 2011 Size: 32,200 s.f.
Role: Research, Lean Design, Medical Planning

Angela worked to incorporate the idea of regenerative design as part of the sustainable strategy through salutogenesis. Universal spaces are easily adaptable as needs change, and lead to a more interactive patient care model as well as sustainable and flexible development. The project has become a health resource within the community through educational programs and events.

- 2015 IIDA Cleveland Design Award
- 2007 Merit Award (Unbuilt) AIA Ohio
- 2007 Merit Award (Unbuilt) AIA Cleveland



CLEVELAND CLINIC HILLCREST HOSPITAL, JANE AND LEE SEIDMAN TOWER AND MAJOR CAMPUS EXPANSION

Completed: 2010
Size: 120,000 s.f.
Role: Medical Planner

Angela developed a multiple core strategy to zone and efficiently handle the high-volume emergency department. Her design doubled the size of the surgery and central sterile departments while improving flows and patient travel distances.

- 2011 AIA Ohio Design Award, Merit Award
- 2011 AIA Cleveland Design Award, Merit Award



SUMMIT TRI-STAR DIGESTIVE WELLNESS CENTER

Completed: 2007 Size: 11,700 s.f.
Role: Project Manager, Medical Planner

Optimized flow of patients, services and staff to avoid exposing patients to the operational side of the facility. Angela led the team in creating a calming healing environment with access to natural light, views and gardens.

- 2009 AIA Ohio Design Awards Merit Award
- 2009 AIA Cleveland Design Awards Merit Award
- 2009 National Commercial Builders Council Grand Award



Academy of Architecture for Health Journal: Editorial Review Committee 2015-Present
Angela reviews research articles on healthcare design topics for this publication.

SIGNIFICANT ACCOMPLISHMENTS

LEADERSHIP IN THE PROFESSION: AIA

AIA NATIONAL

- Leadership Exchange 2021- present
- AIA AEC Research & Academia Advisory Board 2021-present
- AIA Academy of Architecture for Health 2010-present AAH Journal Editorial Committee 201

AIA OHIO

- Practice Innovation Lab facilitator at 2019 OVR
- Practice Innovation Lab Facilitator 2023
- Advocacy Day at the Statehouse 2022-present
- Mentoring Committee 2012

AIA CINCINNATI

- AIA Cincinnati Board of Directors 2016-present
 - Past President 2024
 - President 2023
 - President Elect 2022
 - Treasurer 2021
 - Secretary 2019-2020
- Cincinnati Fellows Council 2021-present
- Women in Architecture Committee 2021 - present
- Impact Grant Juror 2019
- Equity in Architecture Committee 2016-2018
- 2015-Design LAB K-12 Architecture Program 2012 - 2017

AIA CLEVELAND

- AIA Cleveland Government Affairs Committee 2006-2011
Chair 2007-2008

AIA ARIZONA

- AIA Arizona Community Liaison 1999-2002

AIA PHOENIX METRO

Architecture Week Presenter 2000
Angela was active in promoting community involvement by the architecture community and raising awareness of the **power of design to impact quality of life**

“Angela is a future-focused leader in her work and her vision for the profession. She is not only a mentor, but also a facilitator of conversations about critical changes to the profession and an advocate for architects to find meaningful careers. Through her engagement with the local, state, and national AIA, Angela demonstrates a deep commitment to supporting both the next generation of leaders in the profession and encouraging women and others who have historically not been supported in their pursuit of architecture as a career.

Angela is a strategic thinker with broad awareness of the challenges and opportunities facing architecture today.”

Julie Carpenter
Executive Director AIA Cincinnati

AIA REGIONAL CONFERENCE COCHAIR 2019

As AIA Ohio Co-chair, Angela was instrumental in developing the theme of Building Wellness focusing on the relationship between design and well-being.

She assembled a diverse group of AIA members from the Ohio, Kentucky, and Indiana regions to plan this conference, and made it a focus to involve emerging professionals in both the planning and conference events, which included a leadership workshop, student design charrette, and a regional version of the Practice Innovation Lab introduced at the AIA 2018 National convention

Results: Attendance for the event broke records from previous conventions. Attendance met the goal of 25% emerging professionals and 35% mid-career professionals



AIA CINCINNATI STRATEGIC PLAN

Angela led the development of strategic plans for AIA Cincinnati in 2016 and 2021. The 2021 plan included:

- Greater advocacy for the built environment. This strengthened our presence to local government and to taking a proactive stance on local issues.
- Providing more resources for Member professional development and community building. As president, Angela guided committees to consider more joint events and to improve networking opportunities.
- **Inspire all people to seek quality places to thrive.** This has led to community charrettes by the Urban Design Committee, formation of a JEDI committee, and events to educate the public.

AIA VISION LEADERSHIP PROGRAM

VISION is a leadership program that serves architects in the Ohio Valley Region. Angela helps plan sessions, recruit national speakers & moderate sessions. She also teaches one of the segments on the importance of research in promoting rigorous and responsive design through research-based design practices.

Results: Angela has brought nationally known speakers with expertise in issues such as biomimicry, urban design, sustainability, empathy, and digital design to Cincinnati to speak to the chapter. These same experts have impacted the VISION class at half day sessions. Her own sessions on applied research have helped enable practicing architects to understand research does not have to reside in academia and can be seamlessly integrated into an inclusive project process.

- Presenter Research topic 2013-Present
- Planning /Speaker committee 2013-Present
- Session Facilitator 2016-Present



Breaking down the walls in health care design

ACHA President Angela Mazzi talks about the next chapter of the organization

April 28, 2021 | Jamie Morgan



Angela Mazzi, FAIA, FACHA, EDAC, has been bringing a keen awareness of spatial design and its impact on well-being to health care since 2004. Now, she's helping to lead the American College of Healthcare Architects (ACHA) during her term as president. This month, she talks with HFM about her plans to further the organization.

Angela was interviewed by Jamie Morgan an editor of Health Facilities Management magazine about her vision for the profession and role as ACHA President in the next chapter of the organization for the April 2021 issue

SIGNIFICANT ACCOMPLISHMENTS

LEADERSHIP IN THE PROFESSION: ACHA

ACHA is a specialty certification recognized by AIA Certified 2009

Board of Regents 2016 to 2022

- Immediate Past President 2022
- President 2021
- President elect 2020
- Treasurer 2017-2019

College of Fellows Committee Chair 2022

ACHA MASTERS SERIES

Moderator 2021-Present

Angela helped launch an interview series featuring Certificants with expertise in trending healthcare topics. These are hosted on our YouTube channel and are a searchable resource for clients. Topics include, population health, ambulatory care, behavioral health, caregiver wellness, women and children's health.

SUMMER LEADERSHIP SUMMIT PLANNING COMMITTEE

2014-2020

This event is a joint effort of ACHA and the AIA Academy of Architecture for Health Knowledge community. Angela helps plan an advanced education event focusing on emerging issues in healthcare research and practice.

- As ACHA President-Elect, Angela chose the 2020 theme of Resiliency, which the planning committee will work with to plan the upcoming Summit.
- Angela secures sponsorship and promotion of the event. She brought an additional sponsor in 2014, and in 2015 encouraged that sponsor to triple their contribution. In 2018, the SLS featured a record number of sponsors. Beginning in 2017, she pioneered a social media campaign that featured sponsors as thought leaders.

"Angela has successively led several key initiatives for the ACHA on committees, task forces, think tanks, and most importantly the Board of Regents. Following in her footsteps as the 2023 President of ACHA, I know how challenging these positions can be. They require patience, leadership, thoughtfulness, and dedication. Angela has been a role model for me, and others on the Board with her energy, tactfulness, knowledge, and skill-set. Her leadership and contributions to the overall healthcare design industry has made a lasting impact."

Clyde "Ted" Moore III, AIA, ACHA, LEED AP BD+C
Haskell Operations Manager,
Healthcare Architecture
2023 President | ACHA

FUTURE OF HEALTHCARE TASK FORCE 2020-2021

Angela convened a task force of Certificants and allied organizations to examine the healthcare industry. Findings included a shift from healthcare to health, focus on health equity and underserved populations, need for modularity and adaptability, and healthcare beyond buildings.

Results: Published in 2021, the report continues to be an industry resource. ACHA has presented this topic at adjacent industry conferences, published articles and invitations to participate in initiatives with partner organizations.

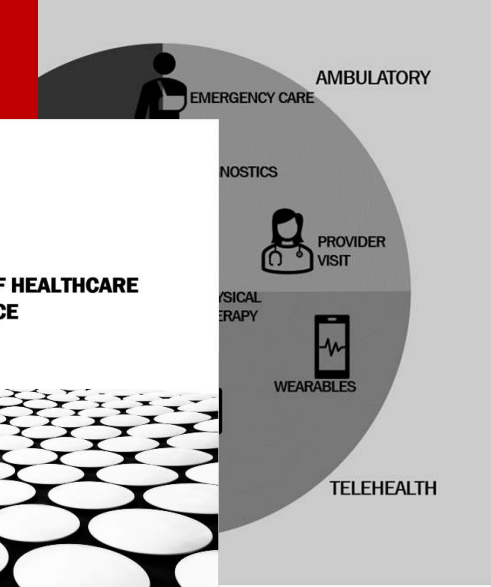

LEGACY PROJECT AWARD

Chair 2015 to 2017, Co-Chair 2014

Legacy awards showcase lasting impact in healthcare design. Angela helped to restructure award requirements and was responsible for convening the jury.

- Panel discussion sessions at ASHE PDC and ACHE Congress showcased the point of view of the jury, owner and architect.
- Led press coverage efforts, including articles and blog posts in Health Facility Management and Healthcare Design magazines.

ADVANCED EDUCATION AND NETWORKING COMMITTEE

2009-2018, Chair 2012-2015

Angela's leadership as chair expanded regional programs and increased educational materials for the resource page of the website.

- Instituted call for white papers to showcase ACHA thought leadership
- Led expansion of regional programs and discussions measuring the value of programs offered by ACHA at both national and local venues
- Developed certificants survey in 2014 for use in promoting an ACHA speaker's bureau. Survey was updated in 2017

NEXT PRACTICES COMMITTEE

2011-2015

A national group of architects, regulators and healthcare professionals who worked to streamline codes and regulations to allow more innovation to emerge in healthcare design. Angela provided research and content to develop a white paper presented at the 2011 AIA California Healthcare Forum. She promoted Next Practices with speaking slots at national conferences.

ACHA STRATEGIC PLAN

While President in 2021, Angela spearheaded a strategic planning effort resulting in a focus on EDI issues, raising awareness of the value of ACHA Certification and promoting the expertise of Certificants. This led to a 25% increase in Certificants and the ACHA Credential to be listed in RFP requirements by Health Systems. The plan included:

- Launch of a social media strategy that showcases Certificants' thought leadership in the industry
- Dedicated LinkedIn group that improved interactivity among Certificants and awareness of one another's work.
- Application of the work of the EDI task force to focus on
 - Diversity of the Board
 - Reworking of Lifetime achievement award resulting in first woman recipient in 2022
 - Reworking of Fellowship guidelines
 - Greater support for those studying for Certification Exam
- Development of a pitch desk to recruit new Certificants
- Stronger industry partnerships with allied organizations



GREEN GUIDE FOR HEALTHCARE PILOT PROJECT 2005-2008

Healthcare projects are energy intensive and must remain operational 24/7. The Green Guide was sponsored by Healthcare without Harm and was a precursor to LEED for Healthcare.

Angela led a team that was one of the first in the industry to explore climate change and health through reduced energy use, clean sources of energy, resiliency of infrastructure and staff well-being.

Angela demonstrates a nationally recognized influence with her research on salutogenesis and medical planning to advance healthcare design. By publishing the results, speaking engagements, and guest lectures nationally and internationally, Angela continues to influence the future of medical facilities. These incredible efforts have been recognized nationally by her peers including advancement to Fellowship by The American Institute of Architects and by the American College of Healthcare Architects (ACHA).

Angela's recognition within the healthcare industry and impact on the profession are most evident in the number of lives that she's influenced. For the more than twenty years that I have known Angela, she has always been steadfast on her commitment to positively impact the profession of architecture in Ohio.

William C. Ayars, FAIA Emeritus, FACHA, MBA
Managing Principal Emeritus Perspectus Architecture

AIA Ohio 2020 Public Service Award

SIGNIFICANT ACCOMPLISHMENTS

INDUSTRY LEADERSHIP AND DESIGN IMPACTS

Angela is a voice in the industry who is an unflinching advocate for design. Her expertise has been sought by clients worldwide. She has worked in Saudi Arabia and consulted on the design of behavioral health facilities in China and Australia. She has also been enlisted to contribute to course curriculum for Steelcase and the American Society of Healthcare Engineers.

Angela has initiated research and design applications and pioneered inquiries into new fields. Research Gate lists her published work in over 100 citations by other researchers in their own work.

Salutogenesis

Her work in salutogenesis has singlehandedly brought this discussion into the mainstream and the toolkit she developed is being used by architects, interior designers and practitioners.

Health Equity

As she further studied salutogenesis as a means of providing resources to cope, Angela realized inequities existed that deprived certain populations of the resources they needed to cope and has studied ways design can restore resiliency.

Areas of expertise

Angela has distinguished herself as a subject matter expert in several healthcare service lines including oncology (cancer care), Behavioral Health, and Staff Environments. She has not only integrated this work into her own projects, but spoken and published articles to advance the delivery of care industrywide.

Integrating research and practice

Research has always been an integral part of Angela's work. She realized early in her career that it was difficult to integrate it into practice. Her work features streamlined processes and strategies to help minimize the risk of innovation for clients.

AMERICAN SOCIETY OF HEALTHCARE ENGINEERS (ASHE)

Angela was one of a small group of architects invited to be interviewed and contribute content for the second edition of their Facility Manager's Handbook.

A Healthcare Project Management e-Course was subsequently developed for release in 2024 and Angela was one of three architects invited to create e-course content.

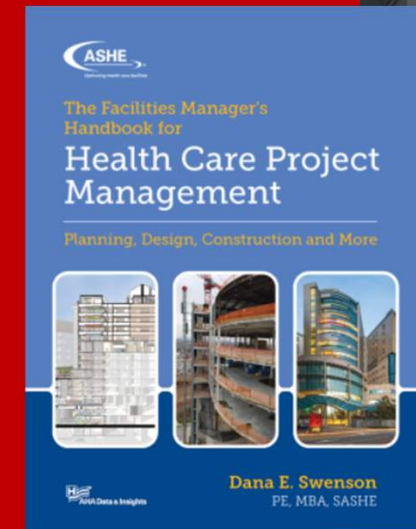

M5 Design in Health Care Project Management

START COURSE

TICAL



STEELCASE ARCHITECTURE AND CONSTRUCTION WORKSHOP

January 2017

The Strategic Health Alliances Leader, Western North America for Steelcase engaged Angela about developing a class they could offer to their dealerships across the country to help them better align their process with the work of architects and contractors. Angela assembled a team consisting of an interior designer, project architect, specification writer and contractor to build the three-day curriculum.

Results: The curriculum led attendees through a project process that incorporated research and strategies for earlier collaboration with the design team. The dealerships learned how to engage with design teams and understand how and when to apply Steelcase research during design to vet design options on their ability to best meet project budgets and goals.



SIGNIFICANT ACCOMPLISHMENTS

SERVING THE INDUSTRY AND COMMUNITY

Institute for Patient-Centered Design Advisory Committee 2012-2016

Angela served on the Advisory Committee for this organization, working to raise awareness of patient and family needs in clinical settings.

- Oncology room design jury
- NICU Prototype room tours
- Board representative for this panel discussion *A Look at the Future of Healthcare Design* HealthTech Facilities Alliance and Council Annual Conference, New Orleans, LA Mar. 2014

Phoenix Revitalization Corporation 1999-2002

Angela helped educate the Central City South neighborhood and help them advocate for a zoning overlay that allowed economic development while preserving its culture and character.

- Board Member 2000-2002
- Designing Healthy Communities Workshop Series Leader 1999

Arizona Forward 1997-2002

Under Angela's chairmanship, the Land Use committee produced a book promoting community advocacy for citizens and an urban redevelopment competition. Angela also helped to launch a transit-oriented design competition that was centered around a central multimodal hub.

- Executive Board 1998-2002
- Land Use Committee Chair 1997-2002

City of Phoenix Housing and Neighborhood Commission 1996-2002

Angela united diverse factions to advance affordable housing and sustainable development policies. including guidelines for affordable housing in an inclusive process that involved community stakeholders as well as members of the City's Finance, Housing and Neighborhood Services Departments

- Commission Chair 2000-2002
- Affordable Housing Subcommittee 1998-2000
- Neighborhoods Subcommittee 1996-1997

"Angela has been so helpful to me as I have emerged into the profession in Cincinnati. She is always super kind and so inviting and makes me feel welcomed into the Cincinnati Architecture community. She is someone that I now consider a mentor. She gave me a safe space to talk about a toxic work environment that I was involved in and helped me work through the best steps to move forward with.

She also has helped me progress my podcast, "Nearly One-Fourth". She has happily participated in campaigns for the podcast and shared her experiences that she has gathered from her own podcast.

Angela is a steward for good in the Cincinnati Architectural community and is beyond deserving of the AIA Ohio Gold Medal."

Hayley Duggins, Associate AIA
Elevar Design Group

JURIES

Angela has been asked to be a juror for competitions, awards and student work.

PROFESSIONAL HONORS

- Juror, ACHA Fellowship 2020, 2024

SPEAKER SELECTION

- PDC Speaker Abstract Reviewer 2018, 2020, 2021
- Healthcare Design Speaker Abstract Reviewer 2020

DESIGN COMPETITIONS

- Juror Academy of Architecture for Health/Steris Healthcare Design Charrette 2021, 2022
- Juror, Kent State University Healthcare Masters Studio 2021
- Juror, AIA Ohio Student Design Competition 2021
- AIA Ohio Safe Schools student charrette 2020
- Juror Family Centered Cancer Care Design Competition 2014
- Product and Booth Awards Judge IDEX/NeoCon 2006

STUDENT WORK

- Drexel Graduate Community Health Studio 2024
- Juror, Masters Thesis Review University of Kentucky December 2014, 2015, 2020, 2023
- Juror, Masters Thesis (wellness in design focus) Miami University May 2014
- Cincinnati Architecture Foundation Design LAB 2014-2017

HIGHER EDUCATION PROGRAMS

Angela helped to design curricula and is often invited to guest lecture for various university programs.

Arizona State University Healthcare Design Program

Advisory Board 2008-2010

This visionary interdisciplinary PhD program formed partnerships with local healthcare institutions as well as design firms to allow students to get real world experience in issues impacting healthcare design.

Results: One of the initial Board members for ASU's healthcare design program, Angela helped shape the curriculum and advance an emphasis on evidence-based practices.

CLASSES TAUGHT-INVITED TO GUEST LECTURE

- Miami University Professional Practice Class Lecture: Creating a Career that Works for you, 2023
- Clemson University Center for Health Facilities Design and Testing, A salutogenic Framework for Behavioral Health, Class lecture 2023
- Drexel University class lecture Salutogenesis and trauma: how our spaces support health 2021
- Designing for Health and Well Being, University of Cincinnati Class Lecture 2018 and 2016
- Bowling Green State University SALUTOGENESIS: Cognitive and Biological Effects of Design, Architecture Series lecture 2016
- University of Kentucky Designing for Health and Well Being, Class lecture 2016, 2022



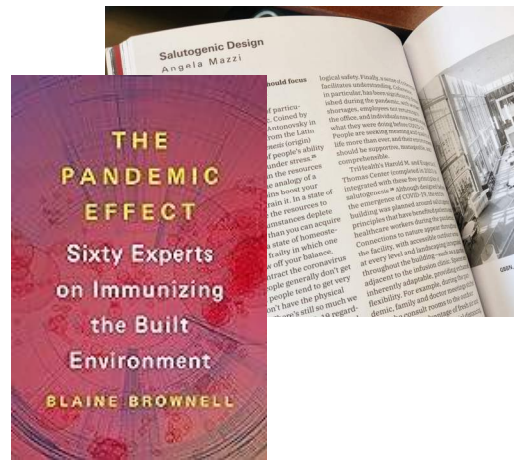

Angela's salutogenic approach to design is featured in Blaine Brownell's latest book on how the built environment can combat the spread of infectious disease.



Angela's work on salutogenesis has been published in HERD: Health Environments Research & Design Journal, a peer-reviewed publication.

"I reached out to Angela based on our Board's familiarity with her work in salutogenesis. It exemplified our Symposium theme of planning of future action in the intersection of design and health. Angela presented and led a working group with our International Advisory Board and Scientific Board to develop recommendations for action and research on the topics she presented. Her talk and impeccable professional conduct helped make the event a high quality one. I am very grateful that she decided to accept my invitation."

Jorge Frascara
Coordinator, SCDH 2023 Symposium
Professor Emeritus, University of Alberta
Member, International Advisory Board,
Swiss Centre for Design and Health

EXHIBITS

LEADERSHIP: ADVANCING SALUTOGENESIS

Angela is an internationally sought after expert on the topics of salutogenesis (health generating design). She has studied socio-cultural issues in architecture throughout her career and became interested in the concept of salutogenesis through her exploration of the link between sustainability and regenerative design. Through her study of psychological, anthropological, sociological, neurological and biological theories, she has come to define salutogenesis as having five distinct aspects:

- **Biophilia:** Experiences that our brain can link to the natural world are naturally calming, while those devoid of such references create stress.
- **Self Efficacy:** Our environment can send the message that we have a measure of control, or it can send the message that we are powerless
- **Relaxation response:** Environments can offer us supportive elements that help trigger our natural ability to calm ourselves, providing positive distractions
- **Sense of Coherence:** Ability to make sense of an environment via analogies between a new spatial experience (or a change to a space we are already familiar with) and something we already know, cultivating familiarity
- **Prospect and Refuge:** Ability to survey our surroundings from a space and choose our level of participation or socialization according to our preferences

Results:

- Salutogenic design has enriched the patient, family, and staff experience in Angela's projects.
- This work has been published in the HERD Journal and she had been invited to speak at venues outside of the healthcare industry like TEDx and SXSW.
- Last year, she was one of four panelist and the only architect to speak at the at the Swiss Center for Design and Health. She will be presenting the salutogenesis toolkit to Mayo Clinic as the first phase of rolling this concept out to health practitioners.

SALUTOGENESIS TOOLKIT

Angela used her research in salutogenesis to develop a toolkit that can be easily used by design teams and clients. Each aspect of salutogenesis contains design prompts as well as examples of its application.

This toolkit distills the research into easily understandable "I" statements. In the works are suggestions of which specific topics are applicable in particular settings like behavioral health or emergency care.



PRESENTATIONS ON SALUTOGENESIS

- Resilience and Health Outcomes: The impact of a salutogenic approach* Mayo Clinic Grand Rounds Featured Presenter Online | October 2024
- Salutogenesis, Equity and Human Factors considerations in design* Mayo Clinic Resilience Engineering Research Team Rochester, MN | July 2024
- Improving our Environment: Exploring the design/health axis*, Swiss Centre for Design and Health Symposium Nidau, Switzerland | July 2023
- Salutogenesis and trauma: how our spaces support health* Drexel University Guest Lecturer Online | April 2021
- Salutogenesis: Design's Cognitive & Behavioral Impact* Heartbeat International Webinar | September 2019
- Salutogenesis in Design* National Maternity Housing Coalition Leadership Meeting, Columbus, OH | June 2018
- Building Wellness: Making people Better Through Design* TEDx, Cincinnati, OH | April 2017
- Home Sweet Home: The Health Hub of the Future South by Southwest Festival (SXSW) Austin, TX 2016
- Healthcare's New Normal: Employing Cognitive Research to Create Patient-Centered Solutions and Promote Wellness* PDC Summit, San Diego, CA | Mar. 2016
- Healthy State of Mind: Psychosocial Triggers to Wellness* Design World Health Congress, Hong King China | July, 2015



Angela and her team spoke about equity and published the paper Improving Healthcare Resilience Through an Equity Focused Framework at the AIA/ACSA Intersections Research Conference: Resilient Future



Tracy Walker, a journalist at Healthcare Design Magazine interviewed Angela and her team on their work for her article "Leveraging the Built Environment for Health Equity" published in the December 2023 issue.

EXHIBITS

LEADERSHIP: ADVANCING EQUITY

ADVOCATING FOR DESIGN EQUITY

Throughout her career, Angela has advocated for design that enhances quality of life. Equity issues are not typically discussed in projects, and Angela has worked to introduce these concepts within the industry as well as one project teams.

Results:

- Advanced the conversation in the industry around how the exposome (environmental and socio-economic factors) impacts resilience and that resilience exists at the scale of a community, a building and an individual.
- Her research has shown how the same resources to cope considered in salutogenesis act as a measure of resilience.
- Development of a Health Equity Framework that can be applied to any project



LEADING THE DISCUSSION

Angela's established work in health equity led AIA Indiana to reach out to her to moderate a panel discussion on Health Equity at their 2023 Healthcare Design Symposium. The panel included a member of Eskenazi Health's Equity Department, a Facility Manager from Indiana University Health and an urban planner

HEALTH EQUITY FRAMEWORK

The framework references industry equity and well being standards as well as Angela's own research on resiliency and social determinants of health. The team devised a system of understanding resilience at the scale of an individual, building and community. The framework presents standards for program elements not typically included in most buildings.

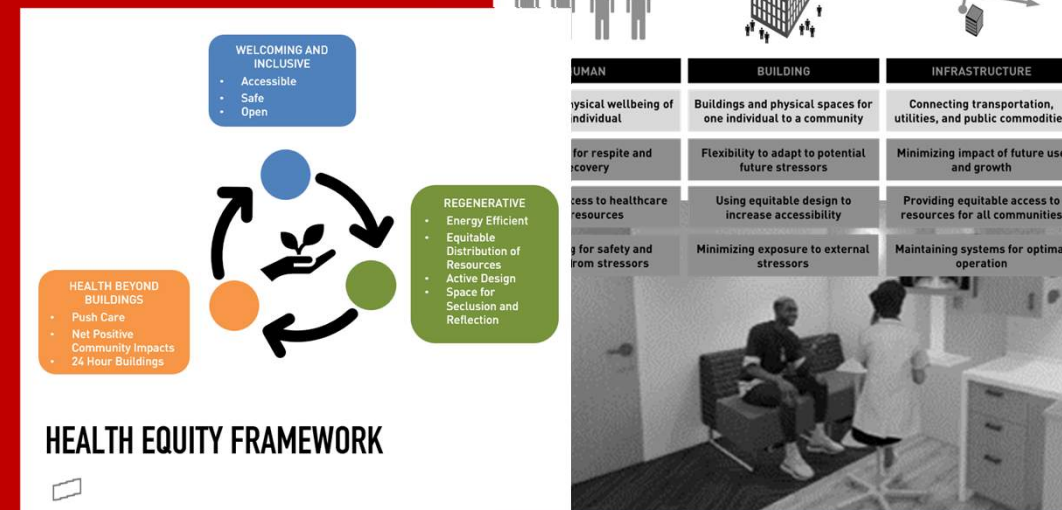

HEALTH EQUITY X HUMAN FACTORS

Chicago March 2024

Angela was invited to join a clinician and a health researcher on a panel to discuss design and equity issues at a Human Factors Conference.

Results: This led to much cross-industry conversation and collaboration. Angela will be sharing her work with Human Factors groups from Mayo clinic and is currently working with a multidisciplinary group of national human factors scholars on a series of white papers.



GBN HEALTH EQUITY SYMPOSIUM

Online March 2023

Angela led the initiative to convene two panel discussions (one of which she moderated) for a discussion of how the Exposome impacts population health and social justice. The panels covered advocacy, governance, partnerships, and how facility design can leverage resources within and outside of the industry to mitigate adverse environmental conditions.

PRESENTATIONS ON HEALTH EQUITY

Integrating Equity into Healthcare Design AIA Pittsburgh Academy of Architecture for Health Online | October 2024

The equity factor: climate social and economic factors that impact well-being AIA Ohio Conference Dublin, OH | September 2024

Equitable Health from Every Angle, International Symposium on Human Factors and Ergonomics in Health Care, Chicago, IL | March 2024

Implementing a Health Equity Framework, AIA Columbus Academy of Architecture for Health Online | March 2024

The Exposome—Going from Ideals to Implementation of Health Equity, Healthcare Design Conference, New Orleans, LA | November 2023

Improving Healthcare Resilience Through an Equity Focused Framework ASCA/AIA Intersections Online | October 2022

Have a Heart how design impacts community wellbeing National Organization of Minority Architects (NOMA), Philadelphia, PA | Oct. 2014

ARCHITECTING

CAREER + LIFESTYLE MENTORING
WITH
ANGELA MAZZI

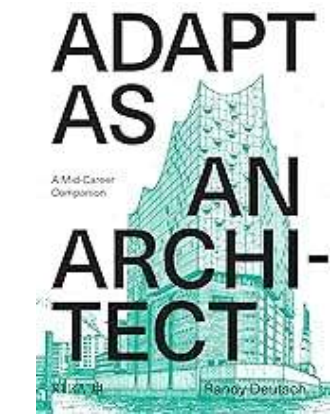

Angela is one of the Mid-Career Professionals featured in Randy Deutsch's recent book. Her insights about leveraging expertise, advocacy, and forging your own career path are featured throughout.

EXHIBITS

SERVICE: ADVOCACY FOR GOOD DESIGN(ERS)

ARCHITECTING Podcast 2021-Present

Angela's podcast was ranked the #20 podcast by moms by Podcast Magazine in 2022. Over 250 episodes cover career and professional development issues, equitable practice strategies, and having an impactful career without sacrificing quality of life. Episodes feature topics that mid-career professionals encounter and include a mixture of solocasts and guest interviews.

Stressless Success Academy

Angela noticed many architects suffering from systemic codependency. She developed this 8-week course offered twice a year helps you define success on your terms.

Salutogenesis for Your Soul live events

This workshop has been offered in both Cincinnati and Chicago and helps architects destress and leverage their potential.

Career Coaching

Angela has successfully coached many architects to get clarity on their purpose and pursue an impactful career.



BOOKS

Angela is the author of two books to help architects in their careers.

Career Crisis 2013

Covers issues like professional development, network building, and dealing with difficult people. The book is designed to help readers get clarity on their career path and be advocates for the opportunities and work style they need for success.

Time Builder 2021

Architects, especially women, are presented with false choices between having a career and a personal life – especially when care of others is involved. As a single mother and firm partner, Angela wrote this book to share insights on how to prioritize, delegate, and establish boundaries.



GLOBAL LEADERSHIP SUMMIT

Executive coach Sarah Francescutti, who is based in Vancouver hosts an annual leadership summit. She has reached out to Angela each year to provide content. Angela has shared insights on having hard talks, time management, creating psychological safety for staff and how to create personally empowering workspace.



CONNECTING VS. DIRECTING INTROVERTED LEADER GUIDE

WHEN YOU WANT TO	DO THIS INSTEAD
PUSH YOUR TEAM	ASK FOR INPUT
BE A LONE WOLF	ASK FOR HELP
GEEK OUT	ASK FOR TAKEAWAYS
BE HYPERPRODUCTIVE	ASK FOR A PAUSE



FREE RESOURCES

There are quizzes and guides available for download as well as supporting materials generated for each episode.





EXHIBITS

SERVICE: ADVOCACY

ARCHITECTS AS HEALERS: BUILDINGS AS MEDICINE Clubhouse Room 2021-Present

Angela cohosts this social audio weekly show with Megan Mazzocco, a journalist and well being advocate based in Chicago. The idea was born from their mutual passion to educate others and raise discourse within the AEC Industry on the powerful impact the built environment has on quality of life.

Sessions feature guest experts talking about how built environment impacts well-being. We explore ways to integrate equity, social justice, climate, and design economics into practice.

Results:

- Over 1000 people are part of the Architects as Healers: Buildings as Medicine Clubhouse community
- Audiences and guests can engage in dialogue and build their professional network of likeminded individuals
- Audience members have reached out to guests to be consultants for client proposals because the guest's work could contribute to their design approach
- Expanded learning and awareness of the myriad ways that design impacts well being coupled with actionable tools to implement in practice.
- 100 sessions and counting- with replays available

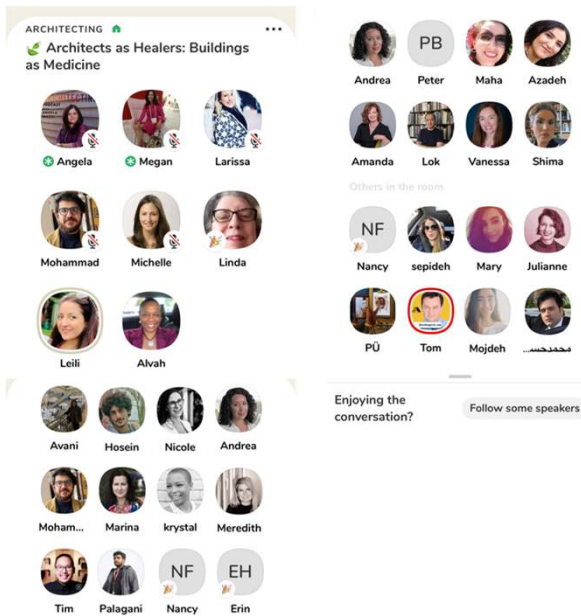

A view of a Clubhouse Session. The interactive format allows listeners to ask questions.

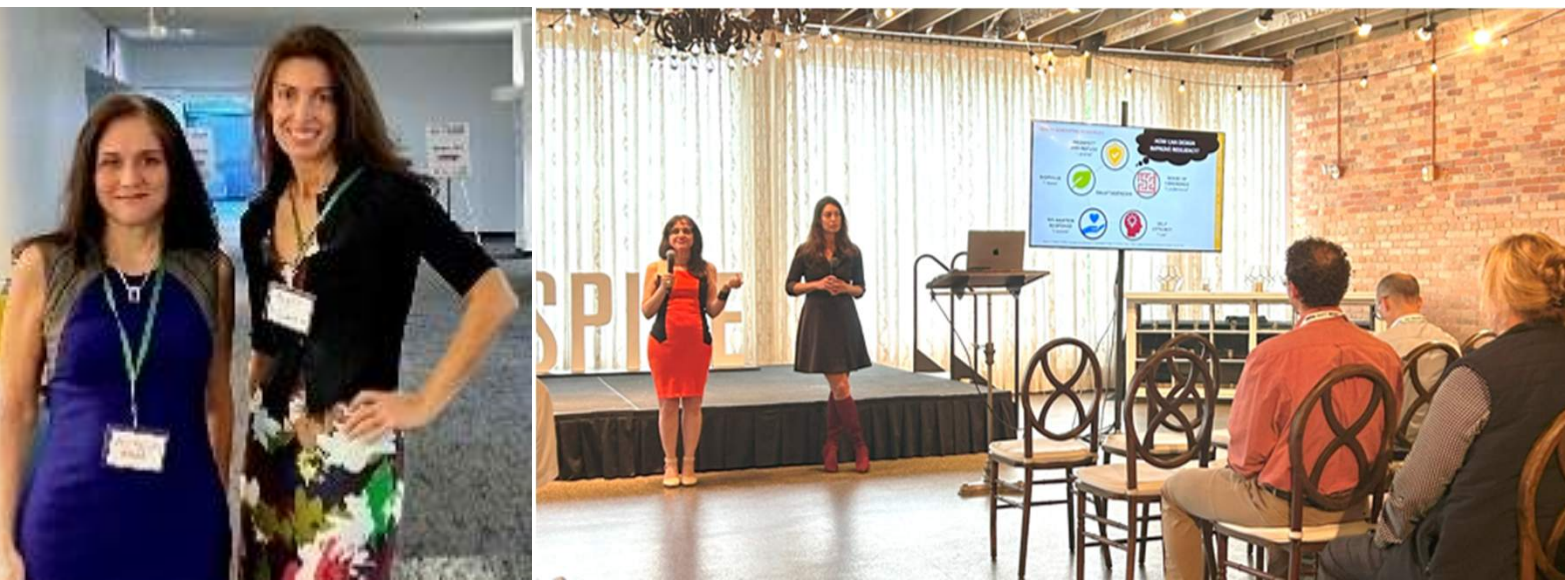

DISCUSSIONS WITH INDUSTRY LEADERS

Guests include leading architects, landscape architects, interior designers, lighting designers, acousticians, urban planners, neuroscientists, artists and more to have lively, provocative and educational discussions.



06.03.24 Guest Ali Heshmati on the circadian system



08.28.23 Guest Esther Sternberg on the role of place for wellbeing at work



09.25.23 Guest Meredith Banasiak on measuring designs impacts on wellbeing

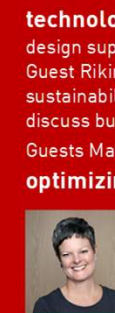

10.24.22 Guest Kira Gould on sustainability and resiliency

05.13.24 Guest B Sanborn on Human and Environmental Design Research 05.06.24 Guest Valentina Cereda on Regenerative Design 04.29.24 Guest Ranem Anwar on Blue Spaces 04.22.24 Guest Binitish Mowjising on Vatsu Practices for wellness 04.15.24 Guest Lukasz Krupinski on Evidence Based Well Being **04.08.24 Guest Eric Corey**

Freed on Neuroenriched Healthcare 04.01.24 Guest Erika

Eitland on Health Equity 03.18.24 Guest Sarika Bajoria on Contemplative Design 03.11.24 Guest Maighdlyn Hadley on the role of Interstitial Space in Well Being 02.19.24 Guest Natasha Reid on Compassionate Design 02.05.24 Guest Steffi Reyes-Thomas on holistic spaces 01.08.24 Guest Cleo Valentine on neuroarchitecture in practice 12.18.23 Guest

Philip Ross on designing affirming mental health environments **12.04.23 Guest Darguin**

Fortuna on Diversifying our viewpoint in the profession 11.27.23 Megan and Angela talk about making the case for wellbeing in design with clients 11.05.23 Hear Angela speak with Greg Coni and Tiffany Broyles Yost on Resilience and Equity **10.30.23 Guest Justin Moench on how**

lighting humanizes space

10.23.23 Guest Dylan Seesman on design for quality of life 10.10.23 Guest Tracy Steward on measuring design impacts 10.02.23 Guest

Anjali Joseph on research tools and systems **09.25.23 Guest Meredith Banasiak on**

measuring designs impacts on wellbeing 09.18.23 Guest Neda Norouzi on design for aging

09.11.23 Livestream from our Aspire Talk **06.05.23 Guest Blaine Brownell on emerging**

technologies to counter noise and light pollution 04.17.23 Guest Christine Malecki West on how human centered

design supports well being 04.10.23 Guest Deborah Wingler on Using research to design for optimal user experience 04.03.23

Guest Rikimah Glymph on Personal resiliency and sustainable work culture 03.27.23 Guest Christina Vernon Sanborn on being a

sustainability advocate **03.06.23 Guest James Shraiky on health equity and prosperity** 02.13.23 Guest Kristin Kahle on the magic of modularity 01.30.23 Angela and Megan

discuss building a better world 01.16.23 Guest Derrick Bransby on mapping space to behavior and operations 12.05.22 Guest Odile Smith on biophilic building 11.28.22

Guests Marty Brennan and Lauri Tredinnick on biological lighting 11.14.22 Megan and Angela talk the Sustainability Network **11.07.22 Guest Dena Prastos on**

optimizing human and ecological outcomes 09.26.22 Guest Micene Fontaine on promoting education and dialogue around public health and social justice

09.12.22 Guest Wayne Turrett talks the convergence of beauty, WELL being, and Sustainability 08.15.22

Guest Brandi Susewicz on upcycling 08.08.22 Guest Ganesh Nayek on design for neurodivergent

populations **07.25.22 Guest Cynthia Fishman on Biomimicry and Quality of Life** 07.18.22

Guest Noam Platt on designing for diverse physical ability 07.11.22 Guest Michael Compton on Well

Being and Facility Design 06.27.22 Guest Tiffany Broyles Yost on integrating sustainability and wellness

platforms 06.20.22 Guest Lauren Schwade on lighting and well being 06.13.22 Guest Tyler Wolf on living walls and community gardens **06.06.22 Guest David Deemer**

on Design Bioethics 05.16.22 Guest Stanton Wong on sustainability standards and assessment tools 05.09.22 Guest Craig Stevenson on passive design 05.02.22 Guest

Adeel Khan on Net Zero Hunger 04.18.22 Guest Rex Miller on healthy workspace 04.11.22 Guest Martina Dresselt on conscious human mobility 04.04.22 Guest Gideon Haris

on affordable housing and equity 03.28.22 Guest Richard Jedon on the psychology of architecture 03.14.22 Guest Bill Coble on manufacturers empowering designers to

improve lives 03.07.22 Guests Elizabeth Monoian and Robert Ferry on beautiful forms of energy 02.28.22 Angela and Megan on Blue Urbanism 02.14.22 Guest Andrew Peck

on wellbeing, sustainability and renewables **02.07.22 Guest Adele Houghton on design**

for equity 01.31.22 Guest Ian Hoffman on Aural Environments 01.24.22 Guest Cheryl Janis on the therapeutic power of art. 01.10.22 Guest JP Bedell on the healing power of lighting 12.13.21

Guest Timothy Hsu on biosocial relationships/medical anthropology 12.06.21 Guest Chas Wiederhold on the imperative of good design 11.22.11 Guest David Navarrete on the bioscience of

experience. 11.08.21 Guest David Chambers on organization management and Lean 11.01.21



01.22.24 Guest Kati Peditto on design for neurodiversity



02.06.23 Guest Anosha Zanjani on the psychology of design



07.26.21 Guest Robin Guenther on Healthcare Without Harm

PRESENTATIONS ON BUILDING WELLNESS

The popularity of the show has led to Angela and Megan speaking about the impact of design on well being at multiple conferences:

Architects as Healers: Design for Human Resilience, ASPIRE Conference, Asheville, SC | September 2023

Sleep and the City Smart Cities Expo Miami, FL | December 2022

Buildings as Medicine: How Better Design Removes Environmental Stressors Midwest Sustainability Conference Cincinnati, OH | June 2022

Exposome vs Genome: Understanding the Built Environment's Effects on Health Outcomes NeoCon Online | June 2022

Architects as Healers: Buildings as Medicine Smart Cities Summit Online | December 2021

“With Angela’s level of passion and commitment, anything is possible. As a single mom, rare female Fellow, and specialist in salutogenesis she is at the forefront of many issues directly serving AIA’s growing focus on equity in the profession. She is a fierce advocate for mental health and a healthy work-life balance! She is a prolific podcaster and blogger, a sought-after international public speaker, just as devoted to her kids as she is to her career.”

Angela is an active, vocal participant- a valued mentor, a knowledgeable guest speaker, and a collaborative team member helping to shape the future of the NEXUS mentorship program for both Fellows and EPs. It wouldn’t be the same without her. I can’t think of anyone who is making a bigger impact on our profession than Angela.”

Carl Sergio, AIA, NOMA, NCARB, LEED GA Director: Bridge Mentorship Program, AIA Chicago 2016-Present
 Director and Founder: NEXUS Mentorship Program 2021-Present
 Director and Founder: Wing Student Mentorship Program, AIA Chicago | 2020-Present
 Young Architect Regional Director: YAF National, AIA Illinois | 2019-2020
 Founder: Emerging Professionals Network, AIA Illinois | 2018

“At the AIA Ohio Practice Simulation Lab, Angela expertly balanced mentorship with questioning established paradigms as she worked with her team to develop a new, innovative business model and then pitch it to the group. As a part of Angela’s team, I witnessed her ability to navigate invitation and challenge in a way that led to success for her team of emerging professionals.

As committee chair for the 2019 AIA Ohio Valley Region Conference, Angela led the development of an event with lasting impact on the profession, including our first Practice Innovation Lab. Her passion for advocacy is shaping both for innovation in practice and advancing wellness in the built environment.”

Matt Toddy, AIA
 2024 AIA At Large Director
 2023 Chair AIA Young Architects Forum
 2022 President AIA Columbus
 Partner Astra Studios

EXHIBITS

SERVICE: MENTORING TOMORROW’S LEADERS

Architecture is a demanding career. It is easy to think that success comes from meeting expectations or emulating a role model. Angela believes that we all have a unique calling, and that success should be defined on our own terms. She has generously given time to mentoring formally and informally, because she wouldn’t have known what was possible if others hadn’t helped push her out of her own comfort zone.

Her mentoring work centers around helping students and young professionals develop leadership skills and cultivate their unique voice as an architect.

Results:

- Angela has maintained relationships with mentees and seen them continue to grow as professionals.
- Over 12 one to one mentees over the last 5 years
- Participation in over 6 different mentoring programs

EMERGING PROFESSIONAL AND STUDENT MENTORING

AIA Ohio Practice Innovation Lab Team leader 2023

AIA NEXUS Mentorship program 2022-present
 Pairs Fellows with emerging professionals for a six month program each year.

AIA Align Mentorship Young Architects Forum and College of Fellows 2022 –present
 Creates pods with 2-3 Fellows and 6 YAF members

AIA Cincinnati VISION Leadership Program 2014-Present

AIA CRIT Scholar Mentor Carnegie Mellon University 2021

Student Thesis Mentor Kent State University Healthcare Design program 2021

Student Mentor Mount St. Joseph College, Cincinnati, OH 2014-15

AAH EMERGING PROFESSIONALS

This group hosts annual panel discussions at the Healthcare Design Conference. Angela was invited to be part of a panel to discuss career path. Attendees are young professionals and students.

Results: Career path options were outlined. Angela also shared ways to get clarity and build a career that has impact.



AIA OHIO PRACTICE INNOVATION LAB

September 2023 and September 2019

After AIA National hosted its first Practice Innovation Lab, they encouraged components to host their own local versions. The emerging professional of the OVR region were excited about this program that helped envision the future of practice. Angela helped facilitate this event at the 2019 OVR Conference. When the AIA Ohio YAF held another session last year, they invited Angela to participate as a group advisor.



STUDENT MENTORING

Angela has been invited to mentor student at multiple architecture programs. In this one-to-one partnering, she has coached students through the research process, developing user centered design concepts and getting clarity on their own interests and passions.

For each mentee, she held regular sessions then had the opportunity to participate in their interim and final presentations.



PRESENTATIONS ON CAREER PATH

Creating a Career that Works for You NEXUS Mentoring Program Guest Lecture Online | October 2023

Following your Unique Career Path AIA Academy of Architecture for Health C2C mentorship panel discussion Online | June 2023

The Advocacy Career Path AIA Academy of Architecture for Health Panel Discussion San Antonio, TX | October 2022

Healthcare Architecture Panel AIA Columbus Emerging Professionals Online | February 2022



Angela helped to develop the GBBN Oncology brochure

EXHIBITS

DESIGN: ONCOLOGY

A SPECTRUM OF CARE NEEDS

Angela is a sought-after expert in the design of oncology environments. She has designed facilities nationwide. Her work has led the industry in the development of:

- Platform based transdisciplinary care
- A focus on the continuum of care from preventative screenings through survivorship
- Development of oncology urgent care models
- Program strategies to seamlessly integrate ancillary services and alternative therapies
- Salutogenic strategies to eliminate stress and empower patients
- Innovative clinical workspace that supports collaboration

A SPECTRUM OF CARE

Seamless, Coordinated, Consistent Evidence-Based Care Across the System

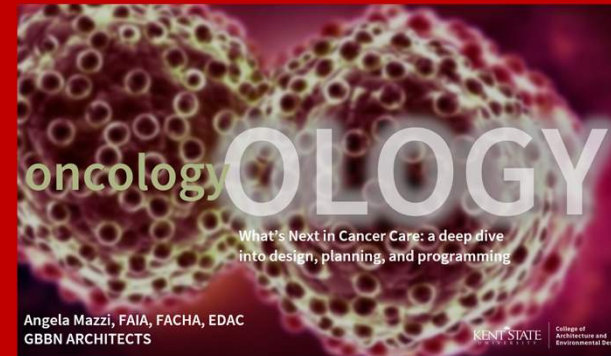
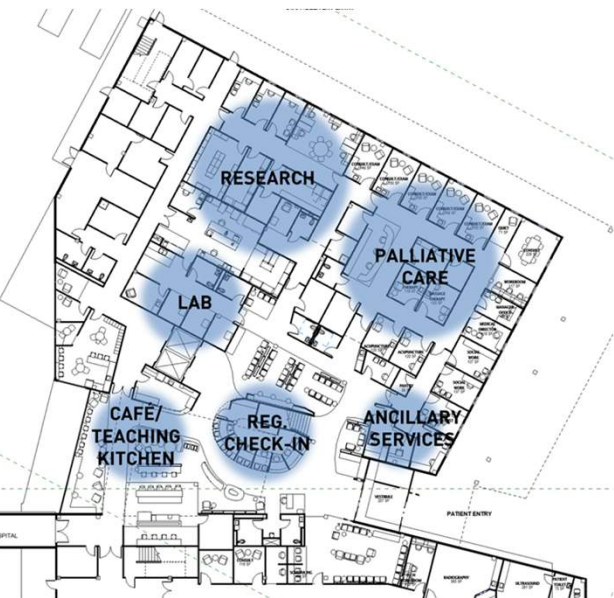
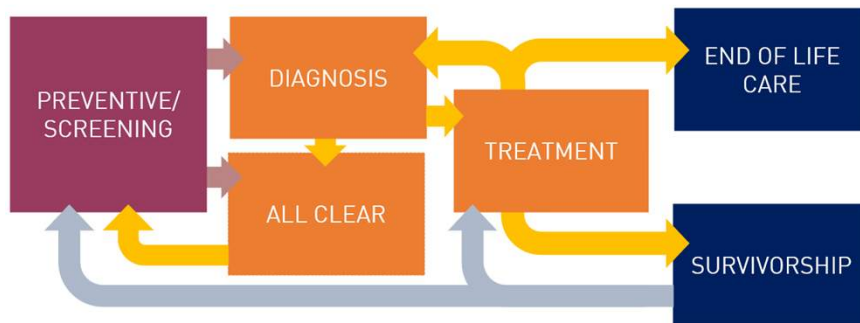

KENT STATE UNIVERSITY COLLEGE OF ARCHITECTURE AND ENVIRONMENTAL DESIGN ONCOLOGY SYMPOSIUM

April 2024

Angela was one of three speakers invited to this symposium. Attendees included healthcare practitioners, facilities managers and students nationwide.

Results: Her talk, Oncology-ology presented a deep dive into what's next in cancer care design, planning, and programming.

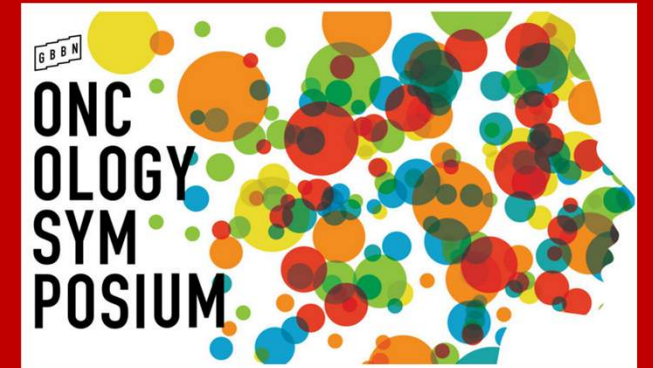

GBBN ONCOLOGY SYMPOSIUM

Online February 2022

Angela spearheaded the first GBBN symposium, helping to select speakers, develop questions for two panel discussions, one of which she moderated.

Results: The panels convened an international online audience of practitioners, administrators, researchers and healthcare designers to discuss both market challenges and oncology trends.

PRESENTATIONS ON ONCOLOGY DESIGN

Oncology Evolution: How Multidisciplinary Care is Impacting Design ASHE PDC Summit Online | September 2020

Lost in Translation? Multidisciplinary Care's Design Impact American Community Cancer Center Conference Washington, DC | March 2020

Identifying the Positive in Oncology Environments Healthcare Facilities Symposium and Expo Chicago, IL | Oct. 2014

ARTICLES AUTHORED ON ONCOLOGY DESIGN

"An Evolution in Oncology Design The keys to planning a platform based and transdisciplinary cancer care facility" *Healthcare Facilities Management* May 2021

"Easing the Oncology Journey: The Role of Urgent Care" *GBBN Insight* September 2020

"A Healing State of Mind: Salutogenesis and Stress in Cancer Care Environments" *GBBN Insight* June 2020



The New York Times

A New Tool in Treating Mental Illness: Building Design

Research into the health effects of natural and man-made surroundings is spurring the development of psychiatric facilities that feel more residential and welcoming.

Jane Margolies, reporter for the New York Times, interviewed Angela along with other national behavioral health design experts for her article on how space can impact treatment published January 5, 2021



Anne DiNardo, Editor of Healthcare Design Magazine, interviewed Angela and other industry leaders on the crisis in behavioral health facilities for her article "Answering the Call" published in the February 2018 issue.

EXHIBITS

DESIGN: BEHAVIORAL HEALTH

A SPECTRUM OF CARE NEEDS

Angela's research on milieu space in behavioral health is setting a standard in the industry for care in lower density settings proven to make care more effective, reduce staff injuries and lower patient aggression. Her work ranges from emergency care and crisis intervention through outpatient, partial hospitalization, inpatient and neurobehavioral design. She has been invited twice by the Center for Health Design to share her research at their annual Behavioral Health Workshop.

- Promote a neighborhood care model with a variety of destinations
- Elimination of hierarchical relationships between staff and patients
- Design for introverts and extroverts
- Use of salutogenic strategies to promote calm

MILIEU RESEARCH

Angela has studied the spectrum of spaces in which treatment has occurred. This work has helped optimize emergency care to focus on crisis stabilization and expansion of programs for intensive outpatient or partial hospitalization instead of inpatient stays, reducing the need for beds. Within inpatient care, her work to develop quality milieu spaces at multiple scales has helped to provide a better patient and staff experience.

Results: Emergency departments reduce need to hold psych patients waiting for beds, patients receive targeted care reducing inpatient length of stay and making therapy more effective.

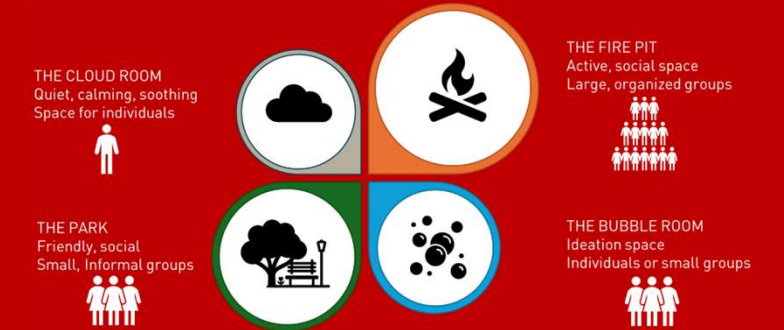
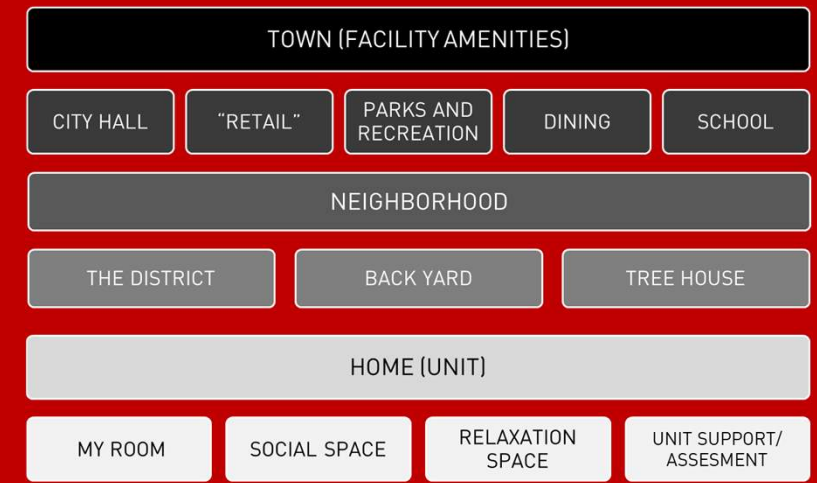

EMERGENCY	HOME	SPECIALIST OUTPATIENT	INTENSIVE OUTPATIENT SERVICES	INTENSIVE INTEGRATED SERVICES	24 HOUR PSYCHIATRY MANAGEMENT
<ul style="list-style-type: none"> • Crisis stabilization, emPATH • Initiate inpatient treatment • Observation 	<ul style="list-style-type: none"> • Telehealth monitoring • Partnerships with non-profits/School • Primary care offices 	<ul style="list-style-type: none"> • Therapist/Counselor • Psychiatrist office • Group therapy 	<ul style="list-style-type: none"> • Care Coordination • IOP Programming • Urgent care/crisis stabilization 	<ul style="list-style-type: none"> • Partial Hospitalization Program 	<ul style="list-style-type: none"> • Inpatient services • Residential program

PRESENTATIONS ON BEHAVIORAL HEALTH

- Neurobehavioral Health* Center for Health Design Mental and Behavioral Health Summit Online | May 2024
- Resourcing Teens in Behavioral Health Settings* Clemson University Guest Lecturer Online | September 2023
- Space for Healing: Providing Patients Resources to Cope* Center for Health Design Behavioral Health Summit Baltimore, MD | September 2022
- The Future of Behavioral Health: Rethinking Milieu* ASHE PDC Summit New Orleans, LA | February 2022
- Salutogenesis and Trauma: How Our Spaces Support Health* Drexel University Guest Lecturer Online | April 2021
- Mental Health Design: Case Studies Panel Discussion* Healthcare Facilities Symposium & Expo, Chicago, IL | September 2016

ARTICLES AUTHORED ON BEHAVIORAL HEALTH

"Milieu: Creating Restorative Environments in Behavioral Health" *GBBN Insight*, February 2020





Angela helped to develop the GBBN Respite brochure



Anne DiNardo, Editor of Healthcare Design Magazine, interviewed Angela and other industry leaders for her article "Mix + Match: Rethinking the Healthcare Workspace" published in the June July 2019 issue.

EXHIBITS

DESIGN: STAFF ENVIRONMENTS

SUPPORTIVE CAREGIVER ENVIRONMENTS

Angela has studied clinical workspace in both inpatient and outpatient settings.

- Body of work that has integrated behavioral research with proxemics to advocate for task-based workspace over traditional role-based ones
- Primary data collected over multiple projects through observations and surveys has been studied as part of an aggregated data base.
- Has led to advocacy of centrality and colocation of workspace
- Produced numerous studies on restorative environments and respite to include multiple

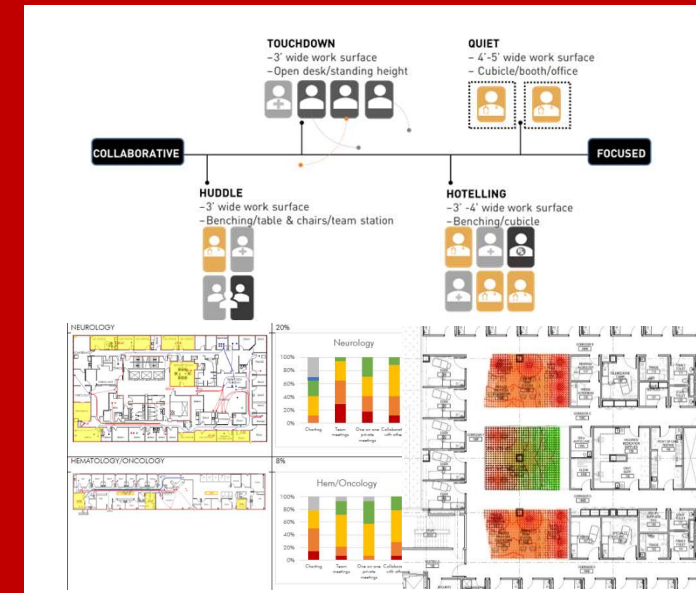

CLINICAL WORKSPACE RESEARCH

Angela has conducted surveys, interviews and observations across multiple healthcare inpatient and outpatient departments to collect data on workspace. By combining this data with proxemics research, she has determined that being centralized and collocated is critical. She has also studied task based vs. role-based workstation configurations and collaborative configuration to support the multidisciplinary teams that work in healthcare today.

Results: Higher clinician satisfaction and collaboration, more time spent with patients.

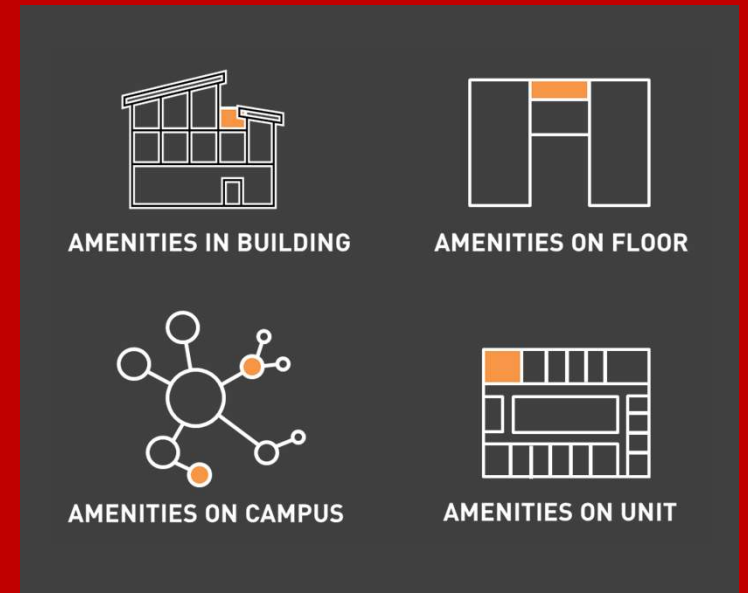

RESPIRE RESEARCH

Staff burnout is a growing crisis. However, an "I'm fine" culture exists in healthcare that makes staff unwilling to admit they need a break for fear of looking lazy or weak. Angela's research includes looking at various forms of rest and restorative experiences that can be provided for staff.

Results: Provision of space for respite has become a standard part of programs for healthcare spaces.



PRESENTATIONS ON STAFF ENVIRONMENTS

Staff ROI: 10 Essential Design Components Your Facilities Should Include to Attract and Retain Staff, ACHE Congress, Chicago, IL | March 2023

Tackling Staff Opt-Out and Burnout: Workspace Antidotes PDC Summit Phoenix, AZ | Mar. 2019

What Does Workspace have to do with It? Radical Approaches to Work and Educational Space Healthcare Design Conference Phoenix, AZ | November 2018

ARTICLES AUTHORED ON STAFF ENVIRONMENTS

"If you build it, will they come? The problem of staff respite in healthcare facilities" *GBBN Insight* August 2022

"The Design Rx for Healthcare's Growing Burnout epidemic" *GBBN Insight* June 2019

"Reworking the Healthcare Workspace" *Healthcare Design* November 2014



Anne DiNardo, Editor of Healthcare Design Magazine interviewed Angela and her team about their upcoming session at the Healthcare Design Conference on strategies to conduct POEs in everyday practice. Her article "Using POEs To Challenge The Status Quo" appeared in the October 2020 issue of Healthcare Design Magazine



After attending the conference session, Anne DiNardo wrote a follow up article "How to Apply Evidence-based Design in Everyday Practice" Which appeared in the November 2020 issue of *Healthcare Design*

EXHIBITS

DESIGN: INTEGRATING RESEARCH AND PRACTICE

Angela was one of the first people to obtain the Evidence-Based Design Accreditation and Certification (EDAC) credential. She believes in conducting primary and secondary research and using a participative co-creation process with project stakeholders during design. She has worked on Post Occupancy Evaluations (POE) in collaboration with academic partners and developed a scalable version that can be done within a firm called POEfficient.

Results:

- Improved project performance because stakeholder voices were heard
- Integration of change management and operation strategies into design
- Methods to rapidly test ideas in ways that encourage user interaction for better feedback.
- Angela has developed a nimble way to conduct research within project teams that is accessible to small and mid-size firms.
- Use existing client metrics to see design impacts

PEER REVIEWER

Angela reviews research articles on healthcare design topics for Health Environments Research and Design (HERD) Journal and the Academy of Architecture for Health Journal.

RETHINKING PROCESS

Design should be "with" not "for" the people who use it. Angela works to include workshops in projects and uses research methods like surveys, focus groups, observations and shadowing to gain information about the "culture" of a space. Together, decisions are made about what should be preserved and how to alleviate pain points and agree on success measurements.

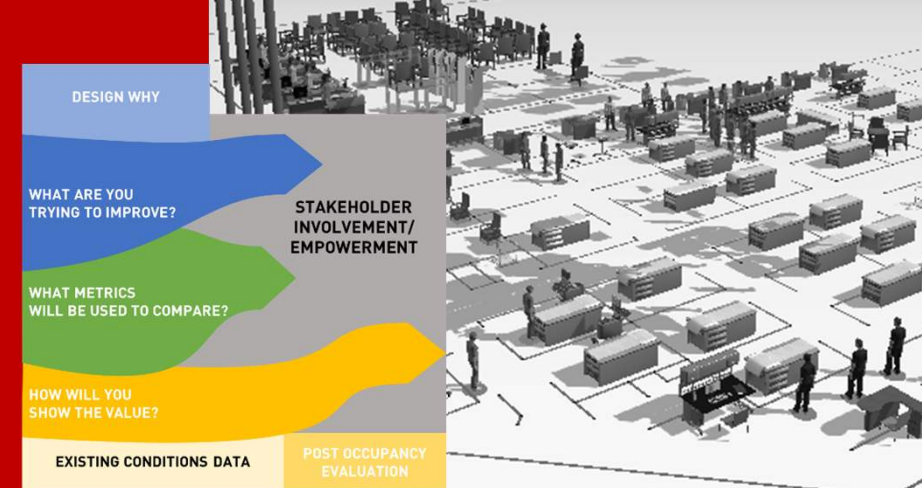

PRESENTATIONS ON RESEARCH AND PRACTICE

Now What? Transition-proofing Facilities Healthcare Design Conference San Antonio, TX | October 2022

Systems Shifting Focus from Healthcare to Health ACHE Congress Chicago, IL | March 2022

In the Wake of the Pandemic: How has COVID-19 shaped the design of greenspaces in healthcare facilities? ASLA Online | October 2021

Multidimensional Design: Implementing Augmented Reality and Simulation Modeling AIA Ohio Technology Summit Dayton, OH | June 2022

POEfficient Healthcare Design Online | November 2020

This Changes Everything BD+C Accelerate LIVE! Conference Chicago, IL | May 2017

A New Brand of Consumers responding to generational and technology advancements to attract and retain the consumer LOTH Healthcare Symposium, Cincinnati, OH | November 2016

Order up! What Retail can Teach us about Designing Environments of Choice AIA Ohio Conference, Akron, OH | October 2016

What We Thought vs. What We Got: What People Really Do in Our Spaces AIA Ohio Valley Regional Conference, Columbus, OH | Oct. 2015

Proof of Concept: Evidence-based design strategies that lead to better buildings AIA Ohio Valley Regional Conference, Louisville, KY | Sept. 2013

A Place for Healing: The Crucial Role of Design in Healthcare Healthcare Innovation by Design Pioneers Webinar Session | Oct. 2012

ARTICLES AUTHORED ON RESEARCH IN PRACTICE

"Reimagining Care Through Evidence: design research, patient-centered solutions, and a culture of care for healthy societies" *DRS2024 Abstract for session track June 2024*

"How simulation can overcome bias and objectively test design performance" *MedHealth Outlook* November 1, 2022

"Mockups in the time of Coronavirus" *Healthcare Design*

"Using Evidence-Based Design to Advance the Healthcare Narrative" *Healthcare Design* November 12 2012



JOHN W. ROGERS, ARCHITECT

2024 June 25

AIA OHIO BOARD – Honor Awards Jury
400 West Wilson Bridge Road, Suite 120
Worthington, OH 43085

Re: AIA Ohio Gold Medal Letter of Support for **Angela Mazzi, FAIA, FACHA, EDAC**

It is my pleasure to provide this letter of support for Angela Mazzi, FAIA, FACHA, EDAC for the 2024 AIA Ohio Gold Medal. She has been a long-time leader in the AIA as well as medical planning and design. I have worked with Angela for more than ten years and have seen the impact she has on our profession. She is changing the future of architecture and health through **service, leadership and design.**

Angela's service has focused on mentorship of students and young architects like AIA Cincinnati's VISION program and last year's AIA Ohio Practice Simulation Lab. She has served on juries and the student design charrettes like the AIA Ohio Safe Schools student competition and the AIA Ohio Student Design Competition. She has worked with ASHE as a content contributor to the Facilities Management Handbook and e-Course content for remote classes. Angela has also served on juries and the student design charrettes held at PDC, HCD and various AIA AAH mentoring and panel discussions.

Angela has provided leadership as Committee chair, Board member and President of the ACHA, she also led the Future of Healthcare Task Force, Strategic plan development and worked to increase the visibility of ACHA. She did the planning of the 2019 OVR conference, including the emphasis placed on programming and opportunities for emerging professionals. She stays involved in AIA Ohio Advocacy Day at the Statehouse, leading the AIA Cincinnati Board of Directors, which developed a strategic plan that restructured how committees collaborate that then created more effective programming. Angela was the first female AIA Fellow in Cincinnati and continues working on the Fellows Council to help coach others through the Fellowship process. Angela is featured in books on practice such as Randy Deutch's [Adapt as An Architect](#) and Blaine Brownell's [The Pandemic Effect](#). She has lead initiatives such as the Architects as Healers Buildings as Medicine podcast that advance discourse on salutogenic topics.

Angela's research in salutogenesis and medical planning experience is advancing how we approach healthcare design. She is speaking and publishing her research as well as teaching classes. This includes guest lecturing and participating on juries at the architecture programs at Kent State, Miami University, University of Cincinnati, Bowling Green, and Mount St. Joseph. Her work to advance wellbeing in design was also recognized in 2022 receiving the HCD 10 Top Architect Award for elevating the application of research in design. Angela also guest lectures at Clemson, Carnegie Mellon and Drexel Universities.

I have enjoyed working with Angela Mazzi over the years experiencing her leadership and service to our profession firsthand and served with her on the ACHA Board and as President of ACHA. I have done projects with her as her client and experienced her leadership and design expertise. It has been impressive to watch her grow her knowledge and impact through research and change the course of healthcare. I believe that her body of service, leadership and design deserve recognition with the AIA OH Gold Medal.

Sincerely,

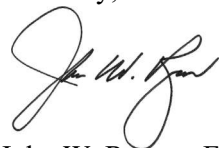

John W. Rogers, FAIA *emeritus*, FACHA *emeritus*, CSI, AMFP
President & CEO, 2015 AIA Ohio Gold Medal Recipient

1634 Larmon Court
Cincinnati, OH 45224-3116

jwrogers1955@hotmail.com
513.535-7566



PROJECT
design group, llc
REGIONAL
design group, llc
HEALTHCARE
design group, llc

A Professional
Corporation

300 Lafayette Street
Suite 200
New Orleans, LA
70130

office 504.523.6472
fax 504.529.1181

June 26, 2024

AIA Ohio
Gold Medal Jury
400 W. Wilson Bridge Road Suite 120
Worthington, OH 43085

Re: Reference for Angela Mazzi FAIA, FACHA

Dear AIA Ohio Gold Medal Jury members,

It is with great pleasure that I am providing this letter of reference for Angela Mazzi regarding the AIA Gold Medal. I have known Angela for over 10 years, as professional colleagues then in various volunteer roles in the American College of Healthcare Architects (ACHA). Angela and I were ACHA committee chairs, then served as members of the Board of Regents before being named Presidents during 2021 and 2022 respectively - as such I can bear witness to her dedication and service to advancing design for staff, patients and visitors of healthcare facilities around the country. It is notable that Angela has been a key representative for healthcare architects in Ohio, one of the largest concentrations of our certificants nationally.

As ACHA President-Elect and President, she guided the organization through the difficult Covid environment, maintaining and strengthening its role as the only AIA-recognized specialty board certification organization while also developing a vision for the future. One of Angela's preeminent accomplishments during her tenure was the widely distributed and discussed *Future of Healthcare Task Force* focusing on a positive future for health and wellness architects. During my presidential tenure, Angela was a critical and trusted advisor and as one of my proudest achievements, in 2021 Angela and I launched and co-moderated the Masters Series 2.0 online learning sessions. These provide in-depth education via a no-cost YouTube channel to make available "graduate-level" practice knowledge in health and wellness design.

Even given the immense effect she had on the ACHA during her leadership, I believe her impact on the industry as an educator is more significant through her numerous educational conference sessions, podcasts and publications. As far back as 2012 she was coordinating and moderating sessions at the AIA Ohio Conference featuring ACHA certificants. Over the past several years I have enjoyed listening to Angela present on her salutogenesis research and the advances it provides for future health design. I fully expect in the coming years this research and design concepts to fundamentally adjust how we practice. Over the past two years, she was requested by the American Society of Healthcare Engineers (ASHE) to serve as a subject matter expert on their recently published Facilities Management Handbook and e-Course.

Aside from being an exemplary leader and educator, Angela also serves as a mentor to younger architects through her podcasts *Architecting* and *Architects as Healers, Buildings as Medicine* which both provide wonderful discussions on wide-ranging topics. And having served on multiple AIA National Academy of Architecture for Health mentoring panel discussions and numerous juries with Angela for student competitions and design charrettes, her commitment to giving back to the next generation of architects is both obvious and important.

Designer: Leader: Educator: Mentor - as an almost 30-year AIA member, it is difficult for me to imagine an architect who has given back to the profession and public in such a substantial manner via multiple volunteer paths. I can explicitly state that Angela has positively affected our profession and the public through her efforts both locally and nationally and I urge your consideration and support for her within your awards program.

Respectfully,



Steve Templet AIA, ACHA, CHID, ASHE, LEED AP



Moody Nolan
300 Spruce Street, Suite 300
Columbus, OH 43215
614.461.4664
moodynolan.com

June 26, 2024

AIA Ohio
Honors Award Jury

RE: Gold Medal Honor Award

To the Jury:

As a recent past chair of the Columbus AAH knowledge component, a Co-Chair of the national AAH KC's, and a member in good standing with the ACHA and AIA, I have had the opportunity to see how Angela Mazzi continues to be the voice that is pushing and shaping our industry in new directions. She continues to mold and craft our profession through her dedication to design, leadership, and service.

As a tireless leader in our industry through both the AIA and ACHA, Angela continues to use her immense experience to both drive the conversation around research and healthcare design as well as to disseminate this information freely, elevating our profession. She has led over 70 speaking engagements and guest lectures as well as authored and contributed to over 30 publications on the topic of healthcare design on both the national and international stage.

In 2019, she helped plan the OVR conference emphasizing emerging professionals and sought to mentor countless professionals through the AAH, while still finding time to participate in AIA Advocacy Day at the Ohio Statehouse. When she and I had the pleasure of serving on a panel conversation in 2022, I saw firsthand how she conveyed concepts that can be put into practice to advance healthcare design to the audience with passion and expertise. This passion led her to help create the ACHA's Master's Series, bringing groundbreaking ideals and innovation to practitioners.

Her commitment to innovation is built on a solid foundation of research. As an EDAC certified professional, Angela's pioneering work on salutogenesis (the study of factors that support human health) and its translation to medical planning has changed how we approach healthcare design. Her work is influential and has been recognized nationally for its impact, by becoming a fellow both in the AIA and the ACHA as well as being the 2022 HCD 10 Top architect award for her focus on advancing wellbeing in design.

Angela's leadership has been a force to reckon with. At every step in her journey, she has made an impact. One that I know I am grateful for her work and I wholeheartedly recommend Angela for the AIA Gold Medal Award. Please do not hesitate to reach out to me if you have any questions.

Sincerely,

Christopher M. Haedt, AIA, NCARB, ACHA, LEED AP BD+C
Principal | Columbus Healthcare Practice Group Leader

June 28, 2024

John Meagan, AIA President

AIA Ohio Board of Directors

400 Wilson Bridge Road
Worthington OH 43085

Re:
Angela Mazzi
FAIA, FACHA, EDAC
2024 AIA Ohio Gold Medal

Dear AIA Ohio Board,

I am honored to nominate Angela Mazzi, FAIA, FACHA, EDAC for the 2024 AIA Ohio Gold Medal. I have known Angela for 4 years when Angela participated in the AIA Leadership Exchange calls hosted by the Strategic Council. Angela's questions were thoughtful and provocative in a constructive requiring thoughtful consideration. I continue to admire Angela's servant leadership, knowledge and generosity.

DESIGN is one of Angela's most compelling traits. Her commitment to design and research in salutogenesis, medical planning experience, and advancing healthcare design is admirable at a local and national level. Her commitment is evident in the number of publications, lectures and volunteer hours through many professional organizations. Angela's work to advance wellbeing in design was recognized in 2022 with the Healthcare Design Magazine 10 Top Architect Award and featured in two books by Randy Deutch and Blaine Brownell.

The act of LEADERSHIP is integral to Angela's personal and professional life. Angela served as a committee chair, Board member and President of ACHA leading initiatives like the Future of healthcare Task Force, Strategic plan development, advancing visibility of ACHA within the industry and re-launching the Masters Series. In 2023, Angela became the AIA Cincinnati President, focusing on quality of programming. Recently, Angela's leadership included rallying support to the newly formed NOMA OVR Chapter.

Angela is the author of two books "*Career Crisis: How to Shake Things Up and Work at Your Highest Level in a Creative Career*" and "*Time Builder: Get more Hours Out of Your Day in a Creative Career*". She is the host of several podcasts including "*Architects as Healers*", "*Buildings as Medicine*" and "*Architecting*". The topics focus on healthcare, career development and equity issues.

Angela's generosity and SERVICE are evident in her participation in lectures, juries and the student design charrettes on several colleges and universities in Ohio.

I have seen Angela's tenacity and enthusiasm to serve, lead, problem solve through design and sharing knowledge to improve the quality of life in Ohio. Angela has made significant contributions to our profession with her leadership, design knowledge and service. It is for these reasons that I unreservedly recommend Angela Mazzi, FAIA, FACHA to be recognized for the 2024 AIA Ohio Gold Medal.

Respectfully submitted,

Yanitza Brongers Marrero, FAIA, NOMA, LEED AP BD+C, LEED For HOMES
MN Partner, Housing Practice Leader.



Moody Nolan
 The Rookery Building
 209 S La Salle Street, Suite 820
 Chicago, IL 60604
 312.929.2516
 moodynolan.com

Knowlton — School

AIA Ohio
 400 W. Wilson Bridge Rd
 Suite 120
 Worthington, OH 43085

**AIA Ohio Gold Medal
 June 2024**

Dear Honors & Awards Committee,

I am writing to highly recommend Angela Mazzi for the AIA Ohio Gold Medal. As her occasional co-conspirator, I have had the pleasure of working with Angela as she leads our profession forward. Throughout this time, I have been consistently impressed by her achievements in design, leadership, and service.

Angela's contributions to healthcare architecture have been nothing short of exceptional. Her research and professional work have not only garnered acclaim but have also positioned her as a thought leader in the industry. Angela's commitment to advancing wellbeing through design has been recognized with prestigious awards such as the HCD 10 Top Architect in 2022. Her innovative approach has been featured prominently in influential publications including Randy Deutch's "Adapt as An Architect" and Blaine Brownell's "The Pandemic Effect". Furthermore, Angela's impact extends beyond her practice, as evidenced by her engagements as a guest lecturer and jury member at Ohio institutions including Kent State, Miami University, University of Cincinnati, Bowling Green, and Mount St. Joseph.

Angela's leadership is marked by her strategic vision and proactive engagement within the architectural community. She has played a pivotal role in shaping the future direction of AIA Cincinnati through her involvement in strategic visioning sessions, where her insights and forward-thinking approach have been instrumental. Angela's dedication to advocating for the profession is evident through her active participation in AIA Ohio Advocacy Day at the Statehouse and her service on the AIA Cincinnati Board of Directors. Her leadership not only fosters collaboration but also empowers emerging professionals to thrive in the field.

Angela was one of the first individuals to welcome me into this community, evidence of her commitment to service extending beyond professional achievements. She has demonstrated a steadfast dedication to mentoring students and early professionals alike through initiatives like the Practice Simulation Lab and her involvement in student design competitions such as the AIA Ohio Safe Schools and Student Design Competitions. Angela's passion for nurturing talent and promoting excellence exemplifies her role as a mentor within the architectural community.

In conclusion, Angela Mazzi's exemplary achievements in design, strategic leadership, and unwavering commitment to service make her an outstanding candidate for the AIA Ohio Gold Medal. Her contributions continue to redefine standards of excellence and inspire future generations of architects.

Please reach out if you have further questions.

Sincerely,

Alexandra Oetzel, AIA
 Adjunct Faculty
 Ohio State University
 oetzel.7@osu.edu

Honor Awards Jury at AIA Ohio

It is with great enthusiasm that I support Angela Mazzi's nomination as a recipient of the AIA Ohio Gold Medal. I met Angela through my work as a healthcare architect, and the national Diversity, Equity and Inclusion leader for Moody Nolan, the nation's largest African American owned firm. I've had the special privilege of working closely with Angela for many years now, and her commitment to advancing the profession resonates.

DESIGN: Angela's national practice work, along with her specialization in salutogenesis (health generating design) positions her not just as a builder of spaces, but a creator of communities. She uses her skills to design environments of care that promote health, well-being, and sustainability. She also advocates, teaches, and inspires the next generation to carry on the work of building a better world.

LEADERSHIP: Angela teaches stakeholders to develop designs that are patient-centered, evidence-based, resilient and sustainable. She uses her leadership in healthcare organizations such as the American College of Healthcare Architects (the only specialty certification recognized by AIA) **and her VISION program** to inspire the next generation of designers to create spaces that are both beautiful and functional. **Her initiatives bring leaders into the field to collaborate, educate and advocate for substantive change.** Her podcast, *Architects as Healers: Buildings as Medicine*, along with her published work and speaking engagements, evolve principles that are aligned with AIA Ohio's tradition of recognizing the exemplary accomplishments of its members.

SERVICE: A social justice architect is a visionary who designs a world where everyone has access to the built environment, regardless of their race, income, or ability. They use their skills to create spaces that promote equity and inclusion, and that empower communities to thrive. Angela embodies these characteristics. She inspires those around her, including young and emerging designers, to be more socially conscious and to act on the issues that matter. Angela is a role model who shows us that it is possible to use our skills and talents to make a difference in the world. The Gold Medal is the highest honor that AIA Ohio can bestow on a member. I fully support Angela's nomination to receive this prestigious honor.

Sincerely,



Roderic Walton FAIA NCARB NOMA Principal - Moody Nolan

June 27, 2024
 Honor Awards Jury
 AIA Ohio
 400 W. Wilson Bridge Road,
 Ste. 120
 Worthington, OH 43085